

SLURRYTUFF™ MAXI-CHECK

SLURRY BALL CHECK VALVES

MODELS H | L

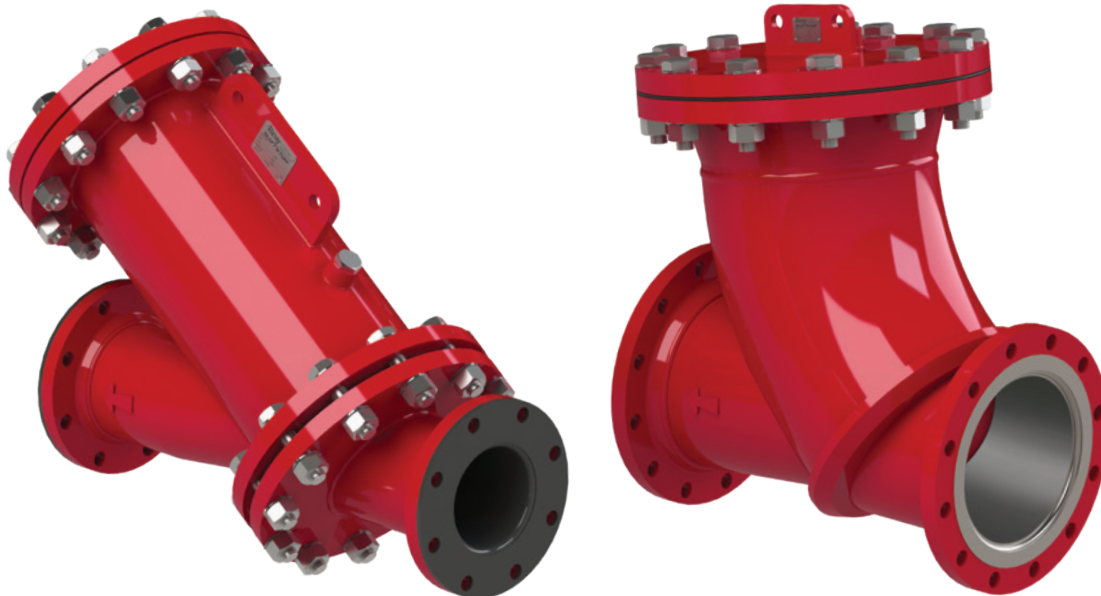

Bray®

WWW.BRAY.COM

THE HIGH PERFORMANCE COMPANY

INTRODUCTION

A RELIABLE INVESTMENT

Bray's SlurryTuff™ brand includes the MAXI-CHECK line of ball check valves, available in high-pressure high-wear, and low-pressure models. They are designed to prevent reverse flow in applications with solids that present significant challenges to other types of check valves.

OPERATING FEATURES

Engineered for slurry service, MAXI-CHECK operating features include:

- > Full bore design — provides unrestricted flow ensuring low pressure loss and minimum back pressure to seal.
- > Large port — prevents clogging.
- > High-wear resistant seat and ball design — offers large sealing area, to provide drip-tight sealing under all conditions.
- > Sinking ball design - preferred for applications involving viscous liquids or slurries.
- > Self-cleaning — the ball rotates during operation eliminating the risk of impurities adhering to the ball.
- > Operation — suitable for horizontal or vertical flow up applications.



OPERATING CONDITIONS

- > Specifically designed for extreme applications, such as slurry, ash disposal, and mine dewatering that produce heavy scale (such as salts).
- > Operating Pressures up to 740 psi (51 bar)
- > Standard operating temperature up to 80°C (176°F).

APPLICATIONS

- > Slurry pipelines
- > Power plant ash disposal
- > Mine dewatering
- > Pipelines with scale
- > Cement plant
- > Pulp & paper
- > Water & wastewater
- > High pressure pipelines



TECHNICAL DATA

SPECIFICATIONS

Purpose	Non Return
Size Range	DN 80 to DN 350 NPS 3 to NPS 14
Temperature Range	Up to 80°C Up to 176°F
Pressure Ratings	ANSI B16.5 Class 150/300 @ 65°C (150°F) Nominal
Connection	Flanged ANSI B16.5 RF Class 150/300

CUSTOMIZABLE FOR YOUR NEEDS

Long-lasting and maintenance-free, all MAXI-CHECK valves are built to meet and exceed the high demands of heavy duty slurry ball check valves. Optional configurations, materials, and linings allow customization to suit your specific requirements.

HIGH PRESSURE SEAT, BALL & SEAL DESIGN

For high-pressure applications over 35 bar, the Model H & Model L valves use a 40 SHORE hardness molded rubber annular seal.

Bubble tight shut-off is achieved by back pressure forcing the seal against the ball.

NOTES

- 1 Shown with Silica bronze sinking ball.
- 2 Molded rubber annular seal.
- 3 Stainless steel seat.
- 4 High pressure O-ring seal.

MATERIALS & OPTIONS

- > Valve body available in carbon steel.
- > Exterior epoxy coatings suitable for highly aggressive environments.
- > Standard inner lining of natural rubber, other options on request.
- > Replaceable ball available in urethane coated aluminum, stainless steel or silica bronze depending on the application.
- > Replaceable seat in 304 stainless steel or hardened carbon steel (matched to the ball).
- > Drain/flush port in body.

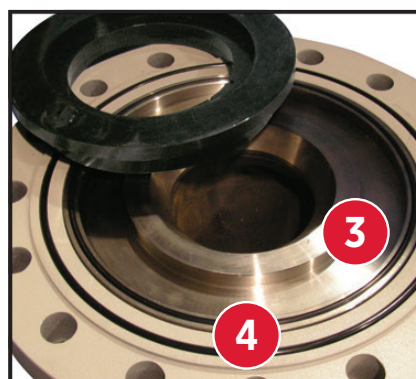
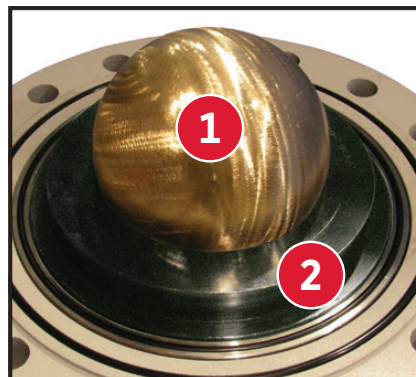

NOTES

- 1 ANSI 150 as standard, consult Bray for other pressure ratings.
- 2 All Bray valves are tested to 110% of rated pressure to ensure bubble-tight shutoff.
- 3 All international flanges available on request. Contact Bray for more information.

AVAILABLE MODELS

MODEL H | High Pressure • High Wear

Ball Check Valve

Ideal for abrasive slurries, this valve features a two-piece split body design with replaceable seat and comes standard with rubber lining and a urethane coated ball. The valve can be configured to suit your particular service conditions with a choice of liner materials and ball types. (refer to page 5 for material options)

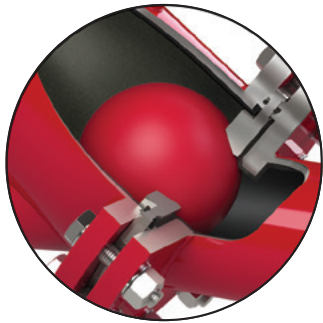

NOTES

1 Valve shown on the closed position

MODEL L | Low Pressure • Low Wear

Ball Check Valve

Robust, simple and cost-effective one-piece body. Designed with the same face to face dimensions as a swing check, allows a direct replacement without the need for pipe modifications and spool pieces.

The valve comes unlined as standard. However, rubber-lined is available on request. Bubble tight shut-off is achieved by back pressure forcing the ball against the integral body steel seat. The advantage of this compact design is a single moving part and no external components ensuring ongoing reliability.

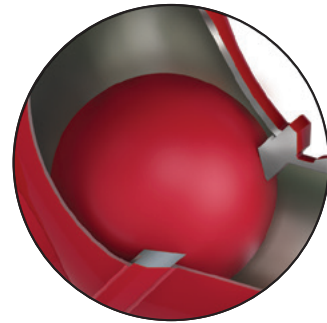

NOTES

1 Valve shown on the closed position



MODEL H

MODEL L

Body & Outlet Cover	Carbon Steel	
Ball (replaceable)	Urethane Coated Aluminum	Urethane Coated Aluminum
	Stainless Steel*	—
	Silica Bronze*	—
Seat (replaceable)	304 Stainless Steel	Carbon Steel (Non-replaceable)
	Hardened Carbon Steel	—
High Pressure Seal (replaceable)	Molded rubber (40 Shore hardness)#	Carbon Steel (Non-replaceable)
Gasket	Nitrile (Buna-N)	
Fasteners	Class 8.8 Galvanized Carbon Steel	
	Stainless Steel option as required	
Internal Lining	Natural Rubber	
	Nitrile	
	Bromobutyl	
Finish	Grit Blast 2.5 and two-part Epoxy Paint	

NOTES

- 1 Other materials may be available on request. Contact Bray for more information.
- * Typically for high pressure applications >35 bar to withstand the mechanical forces.
- # For high pressure applications >35 bar.

FEATURES

FEATURES & BENEFITS | MODEL H

- 1 ORIENTATION:** Suitable for horizontal or vertical installations without any customization required.
- 2 CONSTRUCTION:** Full bore design and simple construction ensures low pressure drop and minimum back pressure to seal.
- 3 BALL:** Self cleaning urethane-coated, aluminum core, stainless steel or silica bronze ball rotates with the flow, preventing scale build up.
- 4 PRIMARY SEAT:** The seat is designed for full-bore flow, and constructed of material selected specifically for slurry and heavy-duty applications.
- 5 BODY:** Fully fabricated from carbon steel for low weight and ease of customization. Lined with a choice of three materials.
- 6 ON-SITE INSPECTION:** Removable bonnet flange for valve inspection, cleaning, or maintenance.
- 7 SEAL TO ATMOSPHERE:** Standard nitrile o-rings are used for a high-pressure seal.
- 8 END CONNECTION:** Available in a wide range of end connections, including ANSI and DIN.
- 9 BODY COATINGS:** The external body have a minimum coat of 250 micron DFT. The body is coated with a hard, two-part epoxy paint, applied in a Bray standard red finish, that provides excellent corrosion and wear resistance.
- 10 FASTENERS:** Fasteners are high tensile galvanized carbon steel structural grade.
- 11 LABEL PLATE:** The stainless steel label details valve model and serial numbers.
- 12 FLUSH PORT:** Based on valve size, either $\frac{1}{2}$ or 1 inch flush port is fitted to depressurize the valve during maintenance, or for flushing when required.
- 13 APPROVED LIFTING LUG:** To aid during installation, or removal.

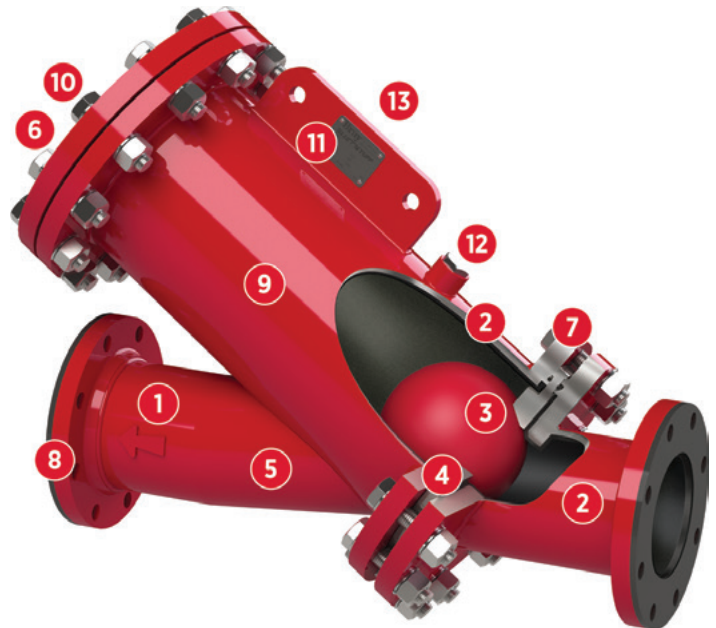

DIMENSIONS & WEIGHTS | MODEL H

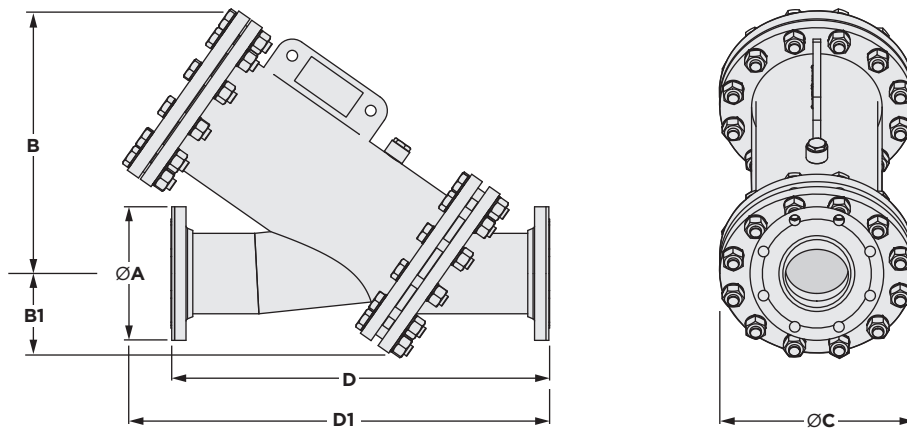

ANSI CLASS 150 | 1960 kPa (mm | kg)

Size DN	ØA mm	B mm	B1 mm	ØC mm	D mm	D1 mm	Wgt (kg)
80	190	366	452	254	490	585	58
100	228	448	433	280	640	694	68
150	280	565	438	406	780	866	177
200	343	664	498	483	930	1005	262
250	406	714	519	533	1070	1140	360
300	483	790	521	598	1120	1246	425
350	533	866	530	635	1460	1470	600

ANSI CLASS 150 | 284 psi (inch | lb)

Size NPS	ØA in	B in	B1 in	ØC in	D in	D1 in	Wgt (lb)
3	7.50	14.41	17.80	10.00	19.29	23.03	128
4	9.00	17.64	5.24	11.00	25.20	27.32	150
6	11.00	22.24	5.43	16.00	30.71	34.09	390
8	13.50	26.14	7.80	19.00	36.61	39.57	578
10	16.00	28.11	8.62	21.00	42.13	44.88	794
12	19.00	31.10	9.88	23.50	44.09	49.06	937
14	21.00	34.09	12.99	25.00	57.48	57.87	1323

NOTES

- 1 Dimensions and weights do not include lining material.
- 2 Dimensions shown are based on ANSI flanging, please consult Bray for other flange types.
- 3 Contact Bray for other ANSI class rated valves.

FEATURES

FEATURES & BENEFITS | MODEL L

- 1 ORIENTATION:** Suitable for horizontal or vertical installations without any customization required.
- 2 CONSTRUCTION:** Full bore design and simple construction ensures low pressure drop and minimum back pressure to seal.
- 3 BALL:** Self cleaning urethane-coated, aluminum core, ball rotates with the flow, preventing scale build up.
- 4 SEAT:** The seat is integral to the one piece fabricated body machined to suite the ball — creating a positive seal under all conditions. The seal is created by the urethane coating and the back pressure on the surface of the seat.
- 5 BODY:** Fully fabricated from carbon steel for low weight and ease of customization. Lined with a choice of three materials.
- 6 ON-SITE INSPECTION:** Removable bonnet flange for valve inspection, cleaning, or modification.
- 7 SEAL TO ATMOSPHERE:** Standard nitrile o-rings are used for a high-pressure seal.
- 8 END CONNECTION:** Available in a wide range of end connections, including AS, PN, ANSI and DIN.
- 9 BODY COATINGS:** The internals (if not rubber lined) and external body have a minimum coat of 250 micron DFT. The body is coated with a hard, two-part epoxy paint, applied in a Bray standard red finish, that provides excellent corrosion and wear resistance.
- 10 FASTENERS:** Fasteners are high tensile galvanized carbon steel structural grade
- 11 LABEL PLATE:** The stainless steel label details valve model and serial numbers.
- 12 FLUSH PORT:** (Not shown) Based on valve size, either ½ or 1 inch flush port is fitted to depressurize the valve during maintenance, or for flushing when required
- 13 APPROVED LIFTING LUG:** To aid during installation, or removal.

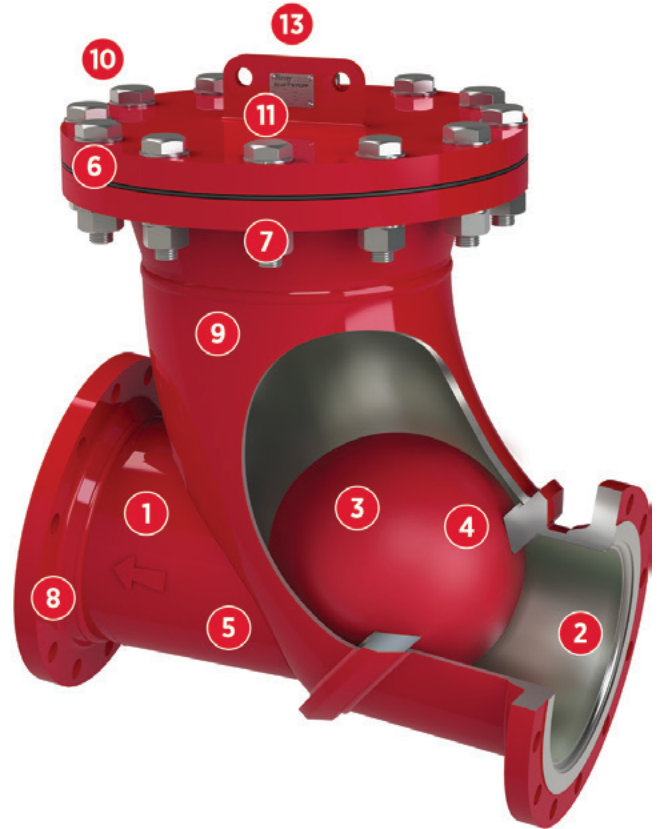

DIMENSIONS & WEIGHTS | MODEL L

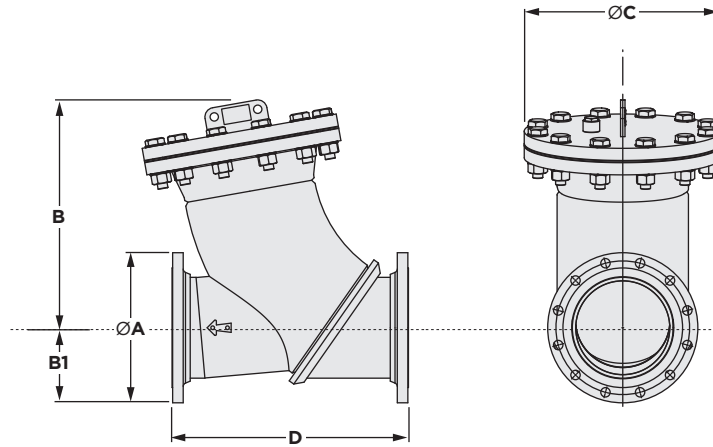

ANSI CLASS 150 | 1960 kPa (mm | kg)

Size DN	ØA mm	B mm	B1 mm	ØC mm	D mm	Wgt (kg)
80	190	327	95	254	260	30
100	228	354	114	280	330	51
125	254	412	127	406	410	60
150	280	438	140	406	410	120
200	343	450	171.5	483	540	170
225	370	617	185	534	610	230
250	406	617	203	534	640	247
300	483	654	241.5	597	700	320
350	533	775	266.5	635	800	395

ANSI CLASS 150 | 284 psi (inch | lb)

Size NPS	ØA in	B in	B1 in	ØC in	D in	Wgt (lb)
3	7.50	12.87	3.74	10.00	66.14	66
4	9.00	13.94	4.49	13.00	112.43	112
5	10.00	16.22	5.00	16.00	132.28	132
6	11.00	17.24	5.51	16.00	264.55	265
8	13.50	17.72	6.75	21.00	374.78	375
9	14.55	24.29	7.28	24.00	507.06	507
10	16.00	24.29	8.00	25.00	544.54	545
12	19.00	25.75	9.50	27.50	705.47	705
14	21.00	30.51	10.50	31.50	870.82	871

NOTES

- 1 Dimensions and weights do not include lining material.
- 2 Contact Bray for other ANSI class rated valves.

PRESSURE DROP | MODELS H • L
DN 80 to 200 (NPS 3 to 8)

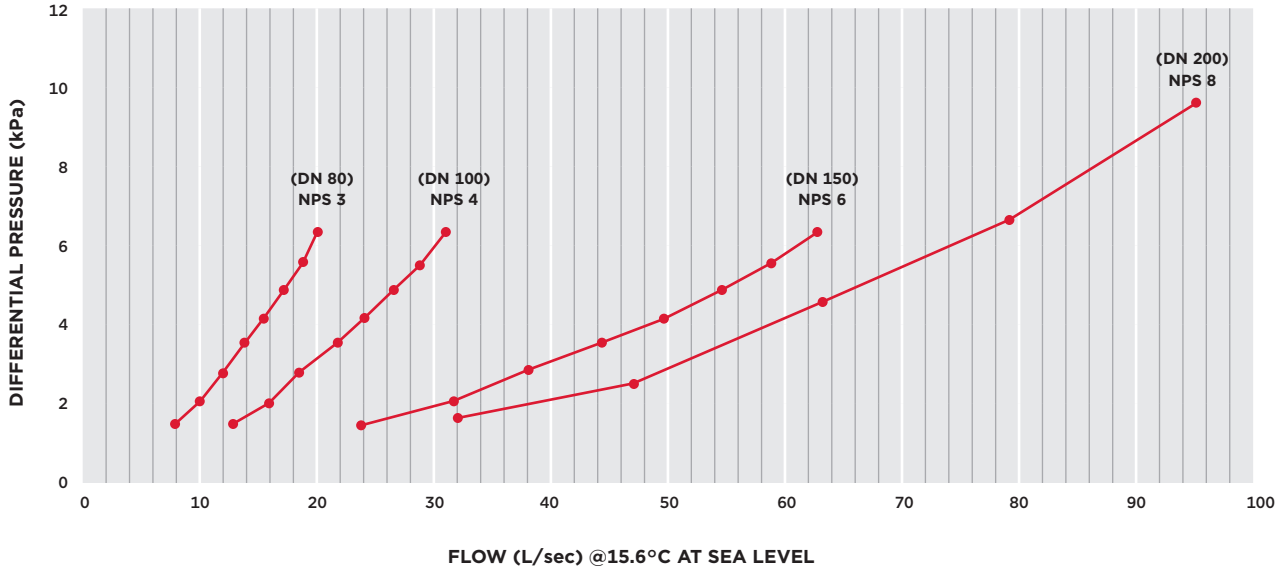

INSTALLATION

INSTALLATION ORIENTATION | MODELS H • L

The Maxi-Check valve is suitable for horizontal or vertical installations without any customization required.

VERTICAL INSTALLATION

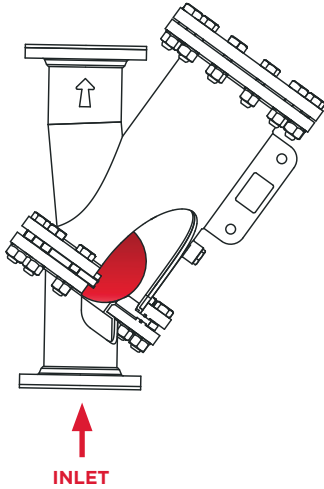

HORIZONTAL INSTALLATION

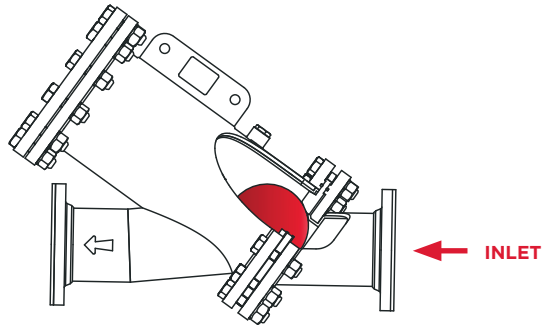

NOTES

- 1 Model H illustrated.
- 2 Valve shown in the closed position.

MEET THE OTHER MEMBERS OF THE SLURRYTUFF RANGE

The SLURRYTUFF™ range of products are designed for arduous applications. We can help with your abrasive, erosive, high pressure and corrosive applications.



EZI-VAC AIR RELEASE / VACUUM BREAK VALVES

A range of air release and vacuum break valves. Available in single-acting and double-acting models, the valves are designed to discharge large amounts of air from pipelines while being filled.

ISOLATION AND SHUT-OFF VALVES THAT FIT YOUR PROCESS

At Bray, we understand you are constantly faced with the need to safely and reliably isolate many different types of processes. To make this easier, Bray has an extensive isolation valve portfolio comprised of high-performance butterfly valves, ball valves, and knife gate valves. These valves are designed and tested to provide the reliability necessary to keep your processes operating at maximum efficiency.



HIGH PERFORMANCE BUTTERFLY VALVES SERIES 40/42 & 41/43

A double offset butterfly valve features an innovative design that offers rugged reliability and bidirectional shutoff to full rated pressure.



BIDIRECTIONAL KNIFE GATE VALVES Series 740

One-piece cast body with flexible wire reinforced elastomer seat for bidirectional zero leakage shutoff in a wide range of industrial applications.



FLANGED BALL VALVES SERIES F15/F30

Two-piece body with floating ball design offers low torque and increased cycle life. An ideal solution for tight shutoff in a wide range of industrial applications.



BIDIRECTIONAL SLURRY VALVES SERIES 768

Two-piece bolted body with twin elastomer seats and a push-through gate designed for bidirectional zero leakage shutoff with self cleaning in demanding slurries.

SINCE 1986, BRAY HAS PROVIDED FLOW CONTROL SOLUTIONS FOR A VARIETY OF INDUSTRIES AROUND THE WORLD.

VISIT **BRAY.COM** TO LEARN MORE ABOUT BRAY PRODUCTS AND LOCATIONS NEAR YOU.

HEADQUARTERS

Bray International, Inc.

13333 Westland East Blvd.

Houston, Texas 77041

Tel: +1.281.894.5454

All statements, technical information, and recommendations in this bulletin are for general use only. Consult Bray representatives or factory for the specific requirements and material selection for your intended application. The right to change or modify product design or product without prior notice is reserved. Patents issued and applied for worldwide. Bray® is a registered trademark of Bray International, Inc.

© 2026 BRAY INTERNATIONAL. ALL RIGHTS RESERVED. BRAY.COM

EN_BPAC_1003_MaxiCheck_20260428



THE HIGH PERFORMANCE COMPANY

BRAY.COM